



Quartz Marble Granite

ZAIM[®]

S T O N E

Quartz is a stone that almost everyone is familiar with. As perhaps the most abundant mineral on Earth, it's worth paying attention to. This quartz stone is also called engineered stone, an artificial stone. **Zaim Stone** has made the first move and becomes the pioneer of manufacturing engineered quartz stone in **Bangladesh**. The only manufacturer in Bangladesh.

Zaimstone Engineered Quartz is a manmade product created from natural Quartz. It's made of around 90 percent ground Quartz and 10 percent Resin and Pigments that are combined into durable and nonporous slabs. The strength of Quartz makes it naturally resistant to abrasion, scratches, dents, and even acids without the need for any sealant. Quartz is an abundant material and the finished product is nontoxic and non-allergenic and will last a lifetime, reducing the need for replacement. So the environmental impact of manufactured quartz is near to zero.

Zaimstone is nonporous and nonabsorbent so it won't draw in moisture from raw or leftover food, which can harbor harmful bacteria.

“

Mission of delivering the world's best stone and stone expertise directly to the customer.

”

Fun Quartz Facts!

Quartz is a chemical compound consisting of one part silicon and two parts oxygen. It is silicon dioxide SiO_2 . Quartz grows in a crystalline structure – that is, it forms in a predictable pattern.



What Does Quartz Look Like?

Quartz comes in all shapes and sizes. It grows in large masses, as well as clusters of points. Once it's in the market, it is often cut or carved into numerous shapes. This can include spheres, pyramids, rectangles, and cubes, and much, much more.

Why Do People Like Quartz?

It is easy to come across pieces that are very affordable! Of course, depending on the size, shape, and or “grade” quality, it may be more or less expensive. But quartz is also beautiful: its clear points can be absolutely stunning!



“

Zaim Stone brings the new trendy stone to your comfort zone. It all depends on your preference.

”

Start Exploration!

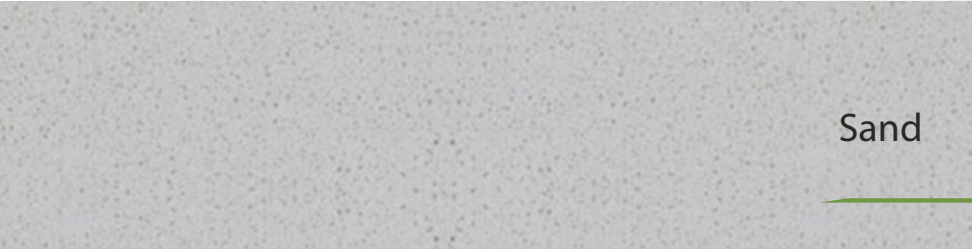
A close-up photograph of the Sand Zaim Stone surface, showing a light grey background with small, dark, speckled granules.

Sand

Made of snow white quartz granules and filler. Recommended to use on interior floor, wall and vanity top.

A close-up photograph of the Pearl Zaim Stone surface, showing a light cream background with larger, translucent, shell-like granules.

Pearl

Made of snow white quartz granules and filler mixed with transparent glass granules. Recommended use for wall and vanity top.

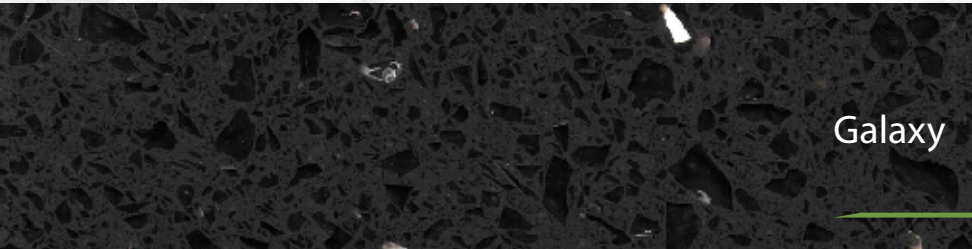
A close-up photograph of the Galaxy Zaim Stone surface, showing a dark, almost black background with small, reflective, mirror-like granules.

Galaxy

Made of snow white quartz granules and mixed with both sided mirror granules. Recommended for wall and vanity top.

Zaimstone offers one slab size (3050 mm by 1525mm) and three thickness options (10,15,20 mm). The slabs are fabricated to fit your project's requirements (size, shape, and edge profile) and are installed in pieces.

Colors of Zaimstone :

One of the appealing features of Zaimstone is its wide variety of colors, patterns, and textures. And the range is continuously expanding. Note that the color and texture of Zaimstone are more consistent than natural stone. The palette leans toward natural shades, but ranges from bright Whites One, of the most popular opinions, to Blacks, Red, Green, Yellow, Blue also all other earth colors like Grey, Brown and Beige.

Patterns of Zaimstone :

The patterns of Zaimstone depends on how the quartz is ground: Coarsely ground stone produces a flecked appearance while finely ground has a smooth look. Also created colours and patterns that mimic natural stones, such as marble and granite, and have even created cement lookalikes an appealing option since cement itself is prone to cracking, chipping and staining.

Finishes of Zaimstone :

Zaimstone has rough, honed, matte, satin, leather or polished surface depending different choices.



Versatile Interior Applications of **ZAIM STONE**[®]

01. Kitchen Worktops
02. Bars
03. Kitchen Wall Tiles
04. Bathroom Wall Tiles
05. Bathtub Tiles
06. Vanity Unit
07. Transparent Walls
08. Tiles
09. Window Sills
10. Stairs Treads & Risers
11. Kitchen Tables
12. Coffee Tables
13. Fireplace Tiling



Galaxy Quartz

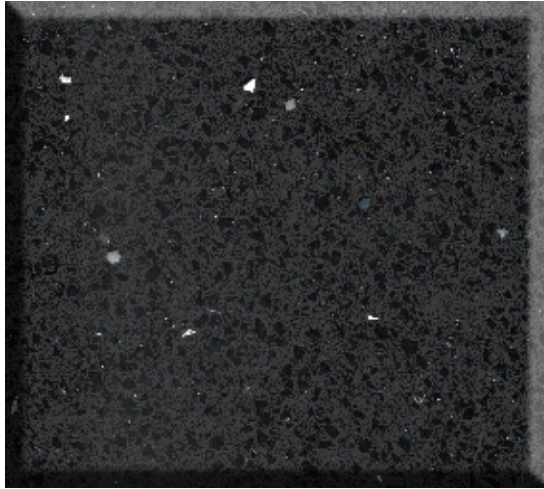

Black Galaxy



Brown Galaxy



Red Galaxy

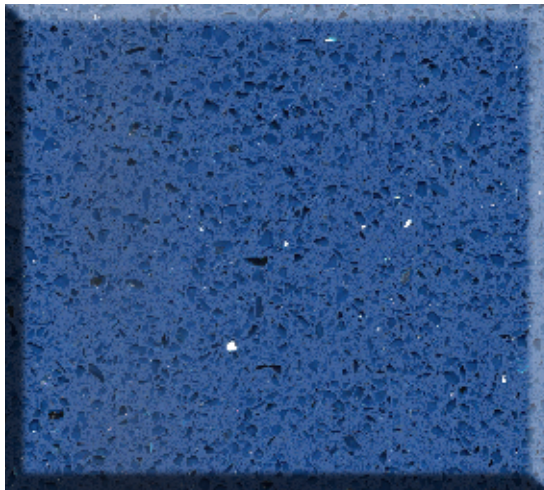

Blue Galaxy

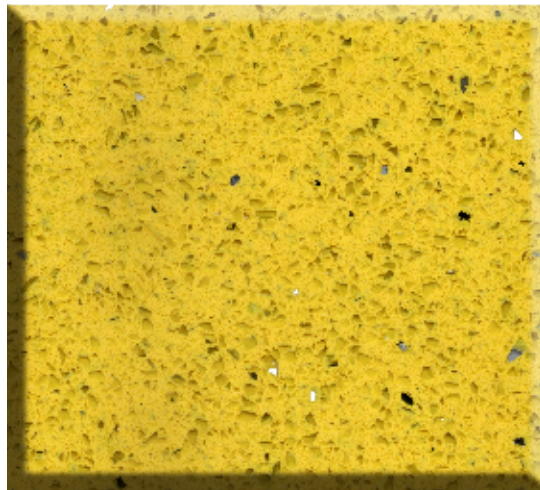

Yellow Galaxy

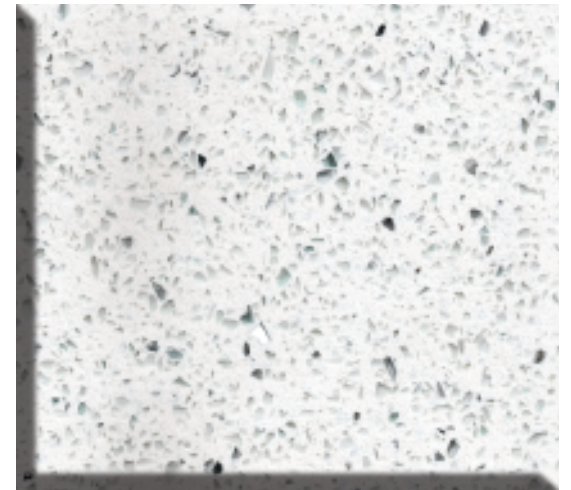

White Galaxy

Galaxy Quartz



Coffee Galaxy

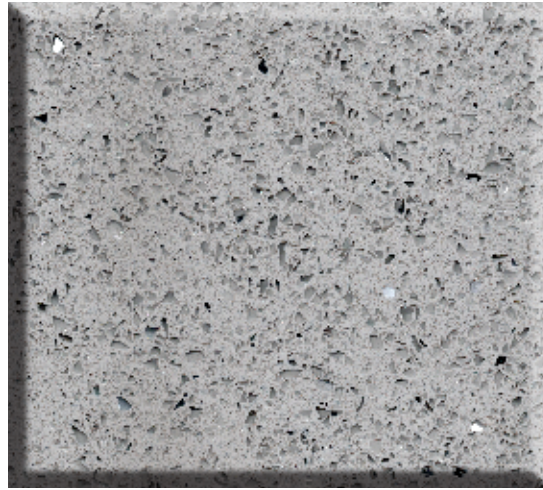

Ash Galaxy



Cream Galaxy

Uses of Zaimstone

Zaimstone is hard, dense, nonporous, nonabrasive, and nonreactive to acids which make it perfect for use as countertops, backsplashes, walls, and floors. Keep in mind that, like natural stone, It's heavy in terms of heat resistance, the material is reportedly not affected by temperature lower than 300 degrees Fahrenheit. Note that it shouldn;t be used outside in sunlight over radiant heat because of possible damage from long-term exposure to heat.

Pearl Quartz



Yellow Pearl



White Pearl



Red Pearl



Cream Pearl



Blue Pearl



Brown Pearl

Pearl Quartz



Ash Pearl



Black Pearl



Coffee Pearl

Sand Quartz

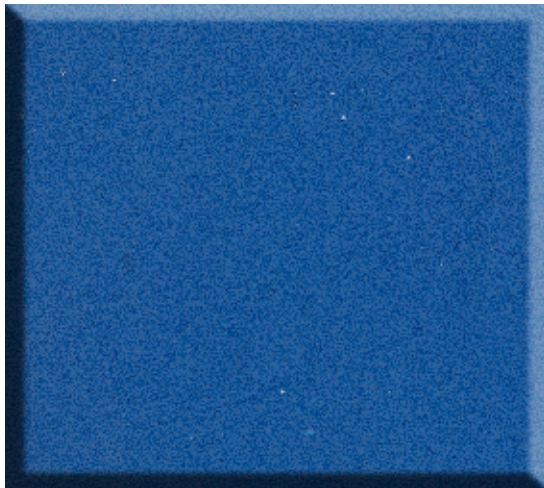

Blue Sand



Ash Sand



Black Sand

Sand Quartz



White Sand

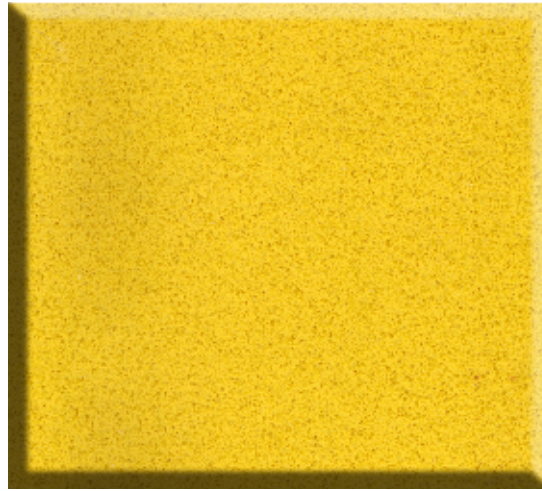

Yellow Sand



Brown Sand



Coffee Sand



Red Sand



Cream Sand

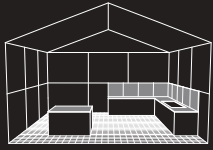

Kitchen Tops and Backs

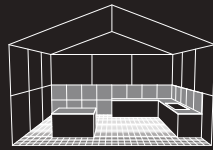

Bathroom Tops

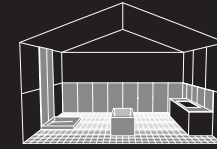

Cladding for Shower and Bath

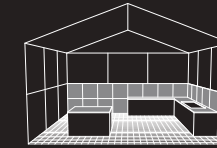

Table Tops and Storage Surface

“
**Popularity
of
Quartz**
”

One of the main reasons quartz has exploded in popularity is due to appearance. Quartz has the look of stone while also allowing homeowners to customize the design. While granite offers many options in terms of appearance, you may have to search for the right piece that matches your colour scheme. Well to cool down, with quartz, the selection process is much easier. Since quartz is engineered, it can be more environmentally friendly than granite if you use regionally manufactured stone and local fabricators.



Shelves

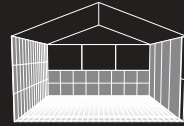

Cladding



Coordinated Decor



Doors and Components

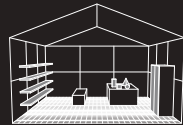

Maintenance

Granite countertops should be cleaned daily with soap and water or a mild household cleaner. Quartz countertops with soap and water or a household cleaner, but that's about it in terms of maintenance. Natural stone surfaces like Granite and Marble require regular sealing and polishing. But Zaimstone countertops are very easy to clean and maintain. Warm water and soap are recommended for day-to-day cleaning. For a stubborn spill, you can use a non-abrasive cleaner such as Soft Scrub. The polished finish will stay intact with no need for ongoing maintenance other than avoiding abrasive cleaners that could dull the surface.

Durability

Granite is a durable material that's resistant to heat and many other kitchen elements. Due to its porous nature though, there can be some staining if spilt liquids are left. Quartz is actually harder than granite and thus, more durable. In fact, quartz is nearly indestructible, and because it isn't porous like granite. Zaimstone is much harder than granite or marble making it more durable. That means Zaimstone is less likely to scratch, chip or stain for years of worry-free service

Zaimstone quartz countertop Recap

- Consistent in color and texture.
- Stain, Scratch, and acid-abrasion resistant.
- Does not require sealing.
- Won't chip and or crack ,thanks to resins.
- Resistant to bacterial growth.

WHY CHOOSE QUARTZ ?

On the quartz surface (heat, oil, wine, coffee and vinegar, even hotpots) things can all be placed with no harm, quartz appears to be the winner. It's easier to maintain, longer-lasting, more environmentally friendly and easy to customize. However, it can be pricey depending on the options you choose and the uniqueness. It adds a level of luxury along durability.

For instance, Quartz features a more attired look. It's more arrayed patterns compared to natural stones. This will be both an obstacle and a plus, counting on your taste. During the manufacturing process, the pigments are added to quartz to vary its colour, add patterns and veins. Due to that, quartz features a very wide colour and pattern selection, which is unmatched.

Choosing engineered quartz slabs for your kitchen or bathroom are going to be a really smart investment; they're going to last you for many years to return.



“

ZAIM STONE IS TAILORED AND INSTALLED DIRECTLY,
BRINGING A FAR SPEEDIER FINISH TO YOUR PROJECT.

”

TECHNICAL SPECIFICATION GLAM STONE QUARTZ

Test performed	Test standard	Result
App Density Kg/dm ³	EN14617-1	2.2-2.40
Water Absorption %	EN14617-1	0.04
Flexural Strength (Mpa)	EN14617-2	50-60
Dimensional Stability	EN14617-12	Class A
Impact Resistance (joule)	EN14617-9	4-9 Joule
Compressive Strength (Mpa)	EN14617-15	170-215
Abrasion resistance	EN14617-4	Groove Length=21mm
Frost Resistance	DIN52104	Complies with standard
Surface Hardness (Mohs Scale)	EN101	6.0-7.0
Stain Resistance	ANSI Z124.6	Pass
Wear & Cleanability	ANSI Z124.6	Pass
Chemical Resistance	ANSI Z124.6	Pass
Chemical Resistance	EN 14617-10	Class C4
Resistance To Acids	ASTM C 650	Not Affected
Boiling Water Resistance	NEMA LD33.5	Pass
High Temperature resistance	NEMA LD33.6	Pass
Slip resistance	EN 14231	Wet: 13-20 SRV, Dry: 43-52 SRV
Thermal Shock Resistance	EN14617-6	No visual defects after 10 cycle. Loss in mass= 0.02%-0.05%. Loss in flexural strength=0.7%-1.1%
Freeze & Thaw Resistance	EN 14617-5	No defects after 25 freeze-thaw cycles
Glossiness Reflection	%	50-75
Static Coefficient of friction	ASTM C 1028	Dry: 0.8, Wet: 0.6



ISO 9001:2008

We love great design. It is our source of inspiration in finding new ways to infuse spaces with color, movement, texture and applications of stone.

ZAIM[®]
S T O N E